



NATIONAL  
HERITAGE  
INSTITUTE

METHODICAL CENTRE  
OF GARDEN CULTURE  
IN KROMĚŘÍŽ

## ■ EDUCATION IN LANDSCAPE

„it is the time you have wasted for your rose ...“

---

Ing. Michaela Letá, Czech Republic



**...it is a long journey**





# ***project: Methodology for Incorporating the Education Related to the Cultural-Historical Heritage in School Education Programmes***

- supported by the European Social Fund within the operational programme Development of Human Resources
- carried by Pedagogical Faculty of Charles University in Prague in 2006-2008
- project outcomes:
  - handbook *Education in Relationship to the Cultural-Historical Heritage*
  - book *Sources of Memory, Seven Chapters on the Cultural-Historical Heritage for Educational Purposes*
  - ten projects on elementary schools



Výchova ke vztahu  
ke kulturně  
historickému  
dědictví

# ***project: Methodology for Incorporating the Education Related to the Cultural-Historical Heritage in School Education Programmes***

- example programme on elementary school in Ostrava named **Ostrava Heap**



2007/2008



Výchova ke vztahu  
ke kulturně  
historickému  
dědictví



# ***project: Cultural Heritage as a Starting Point for Developing Pupils Knowledge and Skills as Part of Education for Sustainable Development of Local Communities***

- supported by the European Social Fund and the Government of Czech Republic in 2009-2012
- project outcomes:
  - handbook *Cultural Heritage and Sustainable Development of Local Communities in School Practice*
  - representative book from International Symposium in 2011
  - in-service training for teachers
  - e-learning Cultural-Historical Heritage Around Us

<http://www.historickededictvi.com/>



Cultural Heritage  
and Sustainable Development  
of Local Communities



# ***project: Cultural Heritage as a Starting Point for Developing Pupils Knowledge and Skills as Part of Education for Sustainable Development of Local Communities***

- example programme on elementary school in Brno, historical-art programme  
**Brno: Way to Know the City**



Cultural Heritage  
and Sustainable Development  
of Local Communities



# ***project: Educational Role of National Heritage Institute: Education as a Key Instrument for Improving Quality of Heritage Management in the Czech Republic***

- carried by Czech National Heritage Institute, Charles University in Prague and Masaryk University in Brno in 2012-2015
- supported by the Government of Czech Republic
- network of seven regional educational centres





# *Enjoying Czech Heritage*





# ***project: Educational Role of National Heritage Institute: Education as a Key Instrument for Improving Quality of Heritage Management in the Czech Republic***

- ***Enjoying Czech Heritage:*** Handbook on Design, Implementation and Evaluation of Heritage Education for Kindergartens and Primary Schools
- ***Enjoying Czech Heritage:*** Handbook on Design, Implementation and Evaluation of Heritage Education for Secondary Schools
- ***Enjoying Czech Heritage:*** Handbook on Design, Implementation and Evaluation of Heritage Learning Programmes for Teachers
- ***Enjoying Czech Heritage:*** Handbook on Design, Implementation and Evaluation of Non-formal and Informal learning in the Historic Environment
- ***Enjoying Czech Heritage:*** Handbook on Design, Implementation and Evaluation of Inclusive Education and Learning in the Historic Environment



# Enjoying Czech Heritage





# project: *The National Centre of Garden Culture*

- Methodical activities
- Scholarly activities
- Educational activities
- Methodical restoration of selected parts of Flower Garden and Chateau Garden in Kroměříž
- carried by The National Heritage Institute, regional department in Kroměříž and its partner The Olomouc Art Museum in 2010-2015





# The Methodical Centre of Garden Culture in Kroměříž





# The Archiepiscopal Chateau and Gardens in Kroměříž



## The Flower garden

early baroque garden



## The Chateau garden

landscape park





# Handbooks Historic Gardens Interpretation and Education

- **Ways of Presenting Monuments of Garden Art Heritage, 2015**
- **Ways of Education in Monuments of Garden Art Heritage, 2015**
- **Tools for Realization of Educational Activities in Garden Art Heritage , 2016**





# Great Educational Potential of Historic Gardens





# What should educator know to interpret historic garden?



- work of a landscape architect
- work of a gardener
- work of a teacher in biology, history, ecology etc.
- work of a historian
- have a musical talent
- know languages
- be creative



# Schools in Historic Garden





# Principles: In the Beginning was the Experience





# Principles: The Piece of Art Is Finished by a Game





# Principles: Building on Historical Sources





# Principles: The Garden Percieved with all Senses





# Principles: Help Me Learn It Myself





# Forms of Interpretation: Art activities





# Forms of Interpretation: Exploring

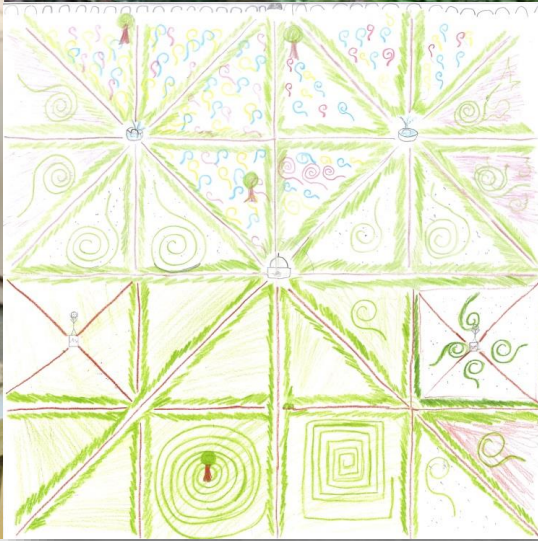



# Forms of Interpretation: The Work experience





# Where Orange Eda Came From

Programme for Kindergartens





# Let's Save Narcissos

Programme for Kindergartens and Primary Schools





# *Garden Is a Game*

programme for Kindergartens and Primary Schools





# The Story of the Flower Garden

programme for Secondary schools





# The Journey We Have Made: Participation and Integration





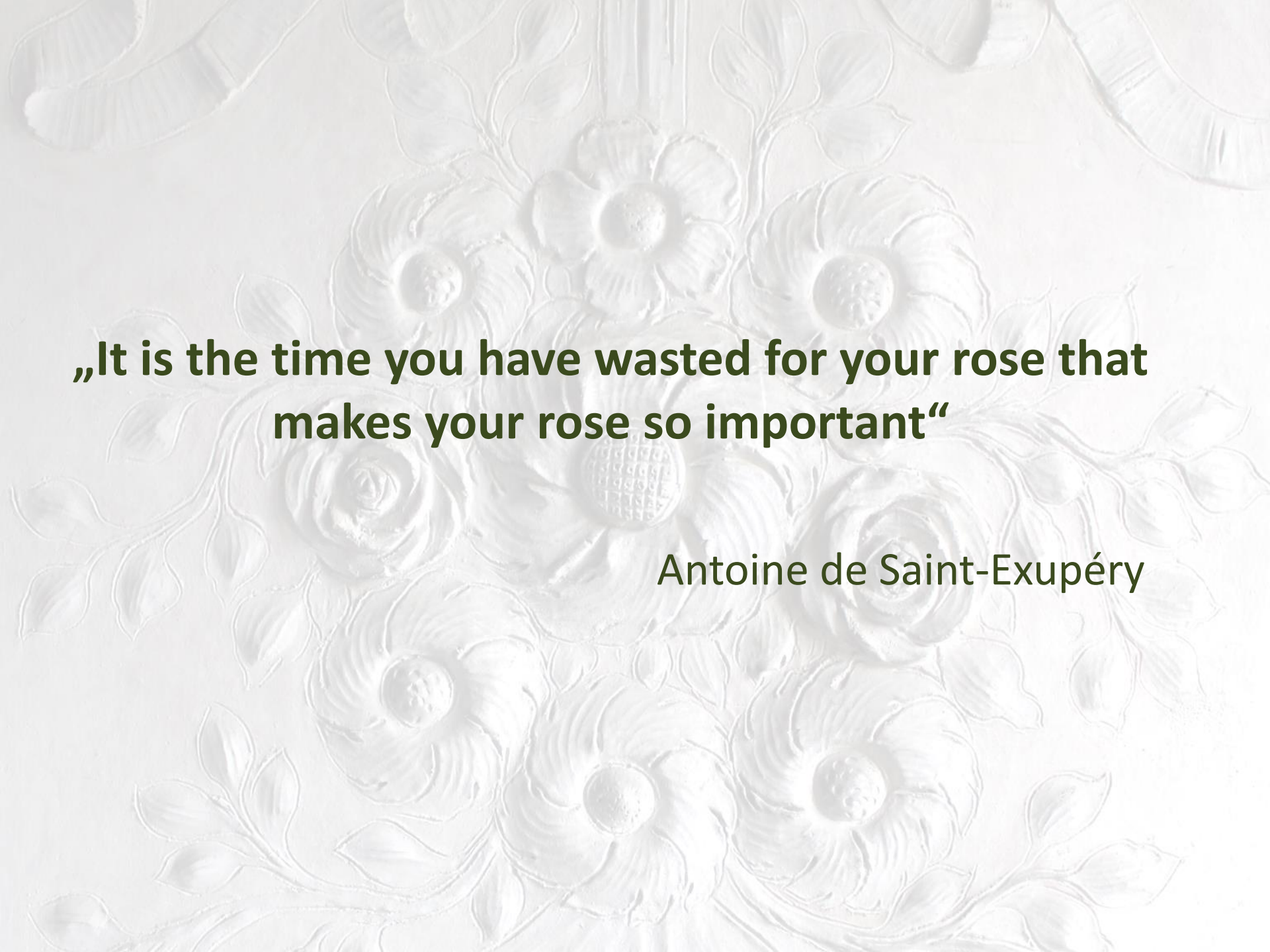

**„It is the time you have wasted for your rose that makes your rose so important“**

**Antoine de Saint-Exupéry**





NATIONAL  
HERITAGE  
INSTITUTE

METHODICAL CENTRE  
OF GARDEN CULTURE  
IN KROMĚŘÍŽ



Ing. Michaela Letá

National Heritage Institute, The Methodical centre of Garden Culture in Kroměříž, [www.npu.cz](http://www.npu.cz)

Authors of photographs: Mgr. Petr Hudec, Ing. Lenka Křesadlová, Ing. Michaela Letá