



**KOPŪSTŲ LAUKAS**

The Cabbage Fields, a civil society initiative working through community art to grow the agency (voice + creative power) of the human person and find institution champions to transform three remaining 19<sup>th</sup> Century ‘winter cellars’ its surrounding parcel of public land into a sustainable public asset.

2011	2013	2014	2015	2016
<p><b>Friendly Zone #3</b></p> <p>Šančiai, Kranto 18-oji g.11. A private house of the Šančiai neighbourhood was turned into an inquiry space of ten city researchers to find out about life and style of Šančiai public spaces. For four days the private house was turned into an alternative public space and hosted an open exhibition and a party for local people.</p>	<p><b>Friendly Zone #4</b></p> <p>Šančiai, Juozapavičiaus p. "Friendly Zone – an inflatable white house was erected on a main street of Šančiai. For four days the house served as a public space and a platform for workshops and showcased the local culture: exhibitions, theatre, music and dance performances took place in it. Eleven Friendly Zone researchers presented community engaged projects and held deliberations about local culture.</p>	<p><b>Friendly Zone #5</b></p> <p>Šančiai, Juozapavičiaus 21E Three times the “Friendly Zone” inflatable house was installed on site that served as a military zone from 1986 until 1993. Because of the remains of the sauerkraut cellars, built in the 19 century, the site is called the “Cabbage Field”. Nine researchers, artists and activists, addressed the issues of the derelict and hugely tainted territory. They engaged local users, collected stories and produced artistic interventions, raising people’s awareness of the potential of the place. The ‘findings’ formed part of a winter exhibition at the local library.</p>	<p><b>Friendly Zone #6</b></p> <p>Šančiai, Juozapavičiaus 21E A site specific land reclamation project. A 13,000 square metres derelict and contaminated site. A small scale physical transformation that will change the image and perception of the site from the negative and hopeless into a promising, creative community development space.</p>	<p><b>Friendly Zone #7 ‘Archivision’</b></p> <p>Šančiai, Juozapavičiaus 21E This involved the planning and realisation of a four day workshop. An international group of artists, architectural students and residents were invited to make plans for the site by working with residents who indeed are real experts.</p>

**2013**

**Friendly Zone #3**

Show community  
culture and identity



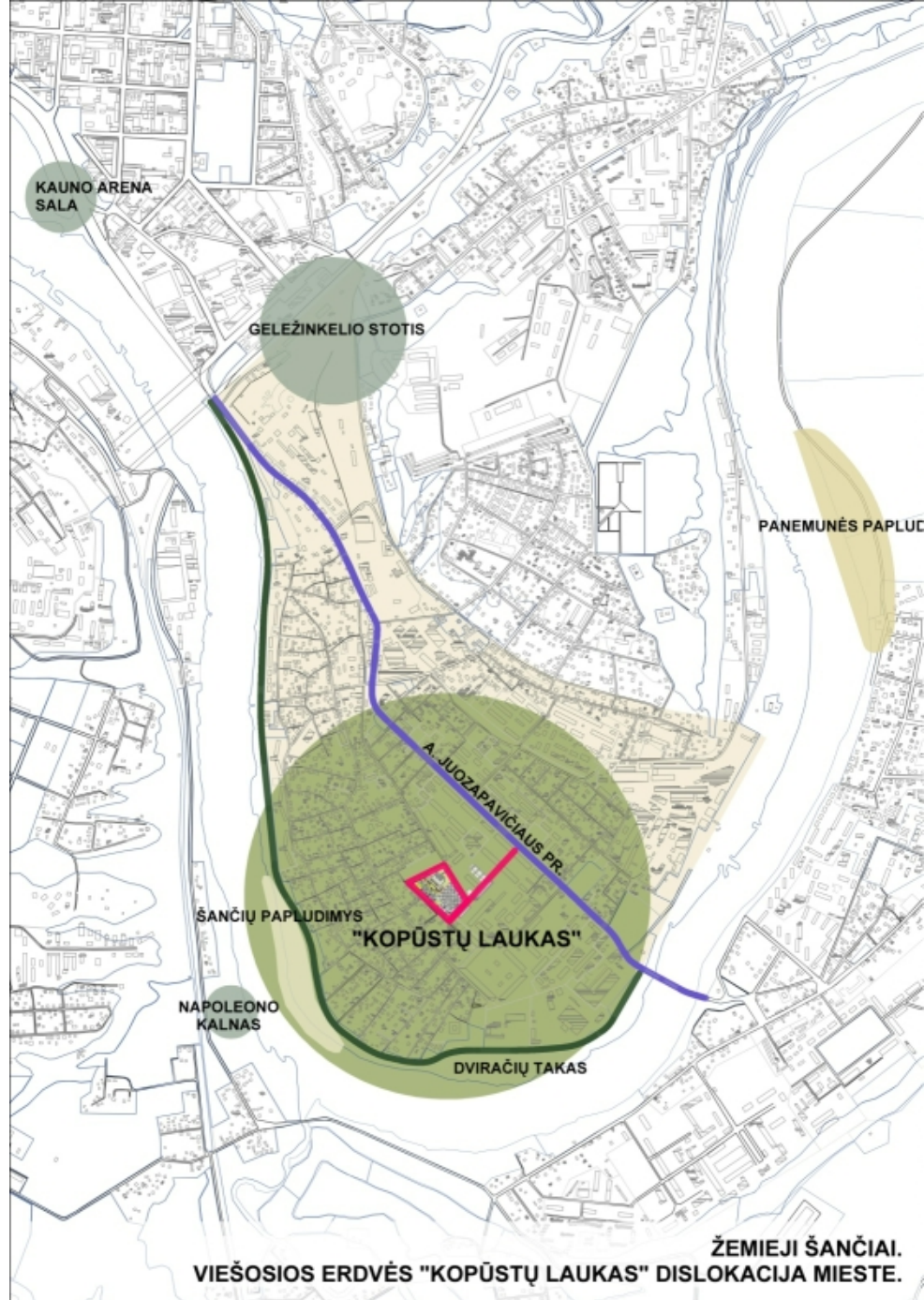







2014

Friendly Zone #5

A group of  
'researchers' from  
2013 chose a parcel  
of public land and  
inhabited it which  
included three sets  
of abandoned  
cultural heritage  
winter cellars







2015

Friendly Zone #6

Clean, clean and more  
clean

New Community  
Association

Cultural led  
programming













2016  
Friendly Zone #7  
Archivision School  
[KAFE/KTU /  
KCFEE] to create  
visions for  
placemaking









Source: *author*

Media yang disediakan dan digunakan secara berkala untuk meningkatkan pengetahuan.  
 Dalam era web, harus dilakukan upaya untuk mengoptimalkan. Tidak ada yang bisa kita pungkasi.

İstanbul'da farklı parçaları kullanarak yapıldı.  
Her bölüme ayrı ayrı 25 tane malzeme verildi ve 20 dakika.  
Ayrıca her bölüme 10 tane malzeme verildi ve 20 dakika.

[illegible][illegible]

Buckley, et al.

[illegible]

Showerhead	Culley
Valkyrie Juvenile	Isis
Marine anemone	Open Space
Zalophi	Green
Gang	Eno
Resident	Skateboard
Looks from outside	Exercise equipment



Stylus: no keyboard

[illegible]

Adverse events:

<sup>11</sup> Li atkūtiši yra pasipildiusios kelių naujovių, tačiau vieta apibūdinti beužtenka. Prie išaktyvimo ligi vieta taip patuolusi ir imitacija kaip apd. supaprastinėjimams: sutvirtinimas, ystikimas, piktikimas, delsimas ir žvargulijimas daktikimas.

100

[illegible]

...and ...

Bendrojoje su gamintoju išnagrinėjus, ką žino patikslinantis šią sąlygą pri vien laipsnį.  
Išties aukšto integracijai būna svarbiausia.

*Mytilus edulis* L.

Hydrus buchari yin aldimingni nasıldigimay, barm qalqy yakt qanday, nasıldigimay, khar dafay vektes.  
Palyatay y inasıldigimay vity, vityne vityne buchari qavayt kagaytu pinyatay, khar khar alimay vitye tay  
Zaynat qalqy vitye vitye vitye vitye tay, tay tay nasıldigimay vitye tay tay.

Transformuokite įėjimo mairių įrašą į duobutę bei įrašą sanduką.  
 Čia būtų lygtiniai uždavimai rasti duobutę bei įrašą, vėliau kurti bei paversti antrą. Taip pat galima būtų pabrėžti įrašo  
 išsivystymą, o duobutės išsivystymą būtų galima išsivystyti.

Fadlanqon: 3 ruzliq daktliq paranasofimant

Peatanga tēpe vāhanga ahauāra dāhāi, tēpe dāhāraa i tēpehāraa.  
 Hāu vāhāra pāhāhāi iā pāhāra tēhāra: pāhāraa, tēhāra dāhāraa i vāhāra.  
 Tēpe pāhāra tēpe pāhāhāi i vāhāra dāhāra tēpe vāhāra.

Fig. 2. (a)  $\log_{10}$  of the probability of a node being infected by a single contact,  $\beta$ , as a function of the number of contacts,  $k$ . (b)  $\log_{10}$  of the probability of a node being infected by a single contact,  $\beta$ , as a function of the number of contacts,  $k$ , for different values of the transmission probability,  $\beta$ .

Apklausimas yra būtinas problemai spręsti.  
 Ypatis švietimo(sių) ir mokytojų (jų) apšvietimo būdais.  
 Tiesiogiai įsijungti į mokymąsi, kad būtų geriau suvokiama.  
 Mūsų švietimo sistema yra geriausia.

Zadaci iz oblasti – primenjena ekologija

Winnipeg takes artists seriously  
not only in providing for national sculpture  
but also in supporting local artists.  
This is the gallery organization delivers.

*Staphylococcus aureus*

Parasitica (with parasitic, often with striding verbals,  
 usually; parasitic but always verb.  
 Plc.: *Artem. equitissima, loricata praefigunt*...

Vandens kalis ryškiai tamsiai brūkšnių ir rausvųjų bei geltonų tofų komponentų pagrais vandens surinkimo stoties  
Naujojojoje ir vandens įėjimo, iš karto tofų vandens  
tarkoj plūmus, augalai išaugo bei toliau  
ar kitais vandens ištekais.



# Kopūstų laukas

History. Nature. Human.



The approach to intervention of "Cabbage Field" refers to three main philosophical aspects: **History** - because it is area with great historical heritage; **Nature** - because this area has wide range of different kind of plants; **People** - because this area must serve to their needs. We decided to arrange space with respect to its conditions: walking paths and walking tracks.

Other - intention of the strategy which UNO supports this project is include them into the part of our project. These - part of natural landscape of the area. We decided to develop them but make a part of new landscape of the area.

Site plan 1:1000



Children

Urban farming

Local community

Tree house

Science and sports

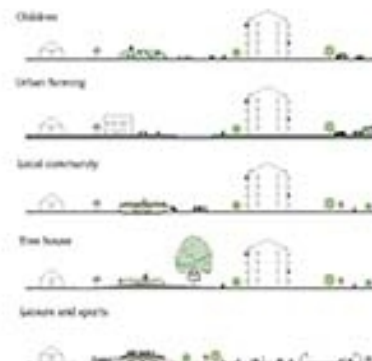

Buildings connected with ground level which is suitable for disabled people. The surface of buildings are used for observation platform (then-extended) line of the area is used as a part of urban landscape with long view on it.

Circulation through the space

Visualizations of the underground galleries and open air stage





2017

Mobilising  
community  
residents and the  
Šančiai Parade  
'Chair'









## Placemaking #1 Faro School for CEE

A 10-day School by practitioners with  
**practices, *ideas* and experiences (pie)**



## Placemaking #2 Winter Cellars

A prototype preservation and prime  
resource





## Placemaking # 3 Dream Bus

Bus as platform to be devised by young people  
without parents.



## Placemaking #4 Flora and Fauna

An experimental station with links to other  
grey zone practices





## **Placemaking #5 Temporary Buildings as Prime Asset**

Two existing temporary spaces will  
be upgraded as new community  
facilities.

