



NATIONAL
HERITAGE
INSTITUTE

METHODICAL CENTRE
OF GARDEN CULTURE
IN KROMĚŘÍŽ

■ EDUCATION IN LANDSCAPE

„it is the time you have wasted for your rose ...“

Ing. Michaela Letá, Czech Republic

...it is a long journey



project: Methodology for Incorporating the Education Related to the Cultural-Historical Heritage in School Education Programmes

- supported by the European Social Fund within the operational programme Development of Human Resources
- carried by Pedagogical Faculty of Charles University in Prague in 2006-2008
- project outcomes:
 - handbook *Education in Relationship to the Cultural-Historical Heritage*
 - book *Sources of Memory, Seven Chapters on the Cultural-Historical Heritage for Educational Purposes*
 - ten projects on elementary schools



Výchova ke vztahu
ke kulturně
historickému
dědictví

project: Methodology for Incorporating the Education Related to the Cultural-Historical Heritage in School Education Programmes

- example programme on elementary school in Ostrava named **Ostrava Heap**



2007/2008



Výchova ke vztahu
ke kulturně
historickému
dědictví

project: Cultural Heritage as a Starting Point for Developing Pupils Knowledge and Skills as Part of Education for Sustainable Development of Local Communities

- supported by the European Social Fund and the Government of Czech Republic in 2009-2012
- project outcomes:
 - handbook *Cultural Heritage and Sustainable Development of Local Communities in School Practice*
 - representative book from International Symposium in 2011
 - in-service training for teachers
 - e-learning Cultural-Historical Heritage Around Us

<http://www.historickededictvi.com/>



Cultural Heritage
and Sustainable Development
of Local Communities

project: Cultural Heritage as a Starting Point for Developing Pupils Knowledge and Skills as Part of Education for Sustainable Development of Local Communities

- example programme on elementary school in Brno, historical-art programme
Brno: Way to Know the City



Cultural Heritage
and Sustainable Development
of Local Communities

project: Educational Role of National Heritage Institute: Education as a Key Instrument for Improving Quality of Heritage Management in the Czech Republic

- carried by Czech National Heritage Institute, Charles University in Prague and Masaryk University in Brno in 2012-2015
- supported by the Government of Czech Republic
- network of seven regional educational centres



Enjoying Czech Heritage



project: Educational Role of National Heritage Institute: Education as a Key Instrument for Improving Quality of Heritage Management in the Czech Republic

- ***Enjoying Czech Heritage:*** Handbook on Design, Implementation and Evaluation of Heritage Education for Kindergartens and Primary Schools
- ***Enjoying Czech Heritage:*** Handbook on Design, Implementation and Evaluation of Heritage Education for Secondary Schools
- ***Enjoying Czech Heritage:*** Handbook on Design, Implementation and Evaluation of Heritage Learning Programmes for Teachers
- ***Enjoying Czech Heritage:*** Handbook on Design, Implementation and Evaluation of Non-formal and Informal learning in the Historic Environment
- ***Enjoying Czech Heritage:*** Handbook on Design, Implementation and Evaluation of Inclusive Education and Learning in the Historic Environment

Enjoying Czech Heritage



project: *The National Centre of Garden Culture*

- Methodical activities
- Scholarly activities
- Educational activities
- Methodical restoration of selected parts of Flower Garden and Chateau Garden in Kroměříž
- carried by The National Heritage Institute, regional department in Kroměříž and its partner The Olomouc Art Museum in 2010-2015



The Methodical Centre of Garden Culture in Kroměříž



The Archiepiscopal Chateau and Gardens in Kroměříž



The Flower garden

early baroque garden



The Chateau garden

landscape park



Handbooks Historic Gardens Interpretation and Education

- **Ways of Presenting Monuments of Garden Art Heritage, 2015**
- **Ways of Education in Monuments of Garden Art Heritage, 2015**
- **Tools for Realization of Educational Activities in Garden Art Heritage , 2016**



Great Educational Potential of Historic Gardens



What should educator know to interpret historic garden?



- work of a landscape architect
- work of a gardener
- work of a teacher in biology, history, ecology etc.
- work of a historian
- have a musical talent
- know languages
- be creative

Schools in Historic Garden



Principles: In the Beginning was the Experience



Principles: The Piece of Art Is Finished by a Game



Principles: Building on Historical Sources



Principles: The Garden Percieved with all Senses



Principles: Help Me Learn It Myself



Forms of Interpretation: Art activities



Forms of Interpretation: Exploring

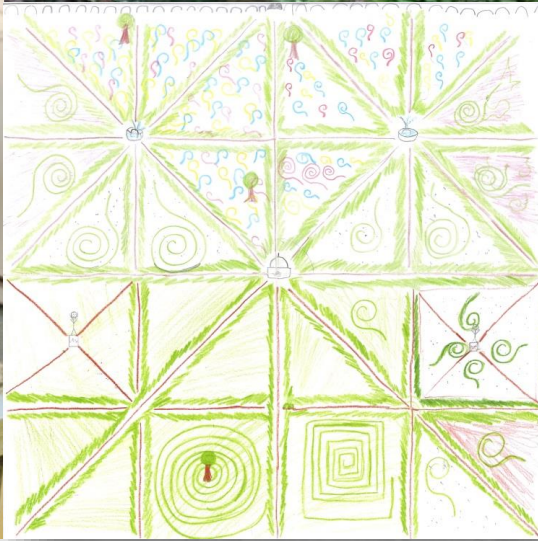

Forms of Interpretation: The Work experience



Where Orange Eda Came From

Programme for Kindergartens



Let's Save Narcissos

Programme for Kindergartens and Primary Schools



Garden Is a Game

programme for Kindergartens and Primary Schools



The Story of the Flower Garden

programme for Secondary schools



The Journey We Have Made: Participation and Integration



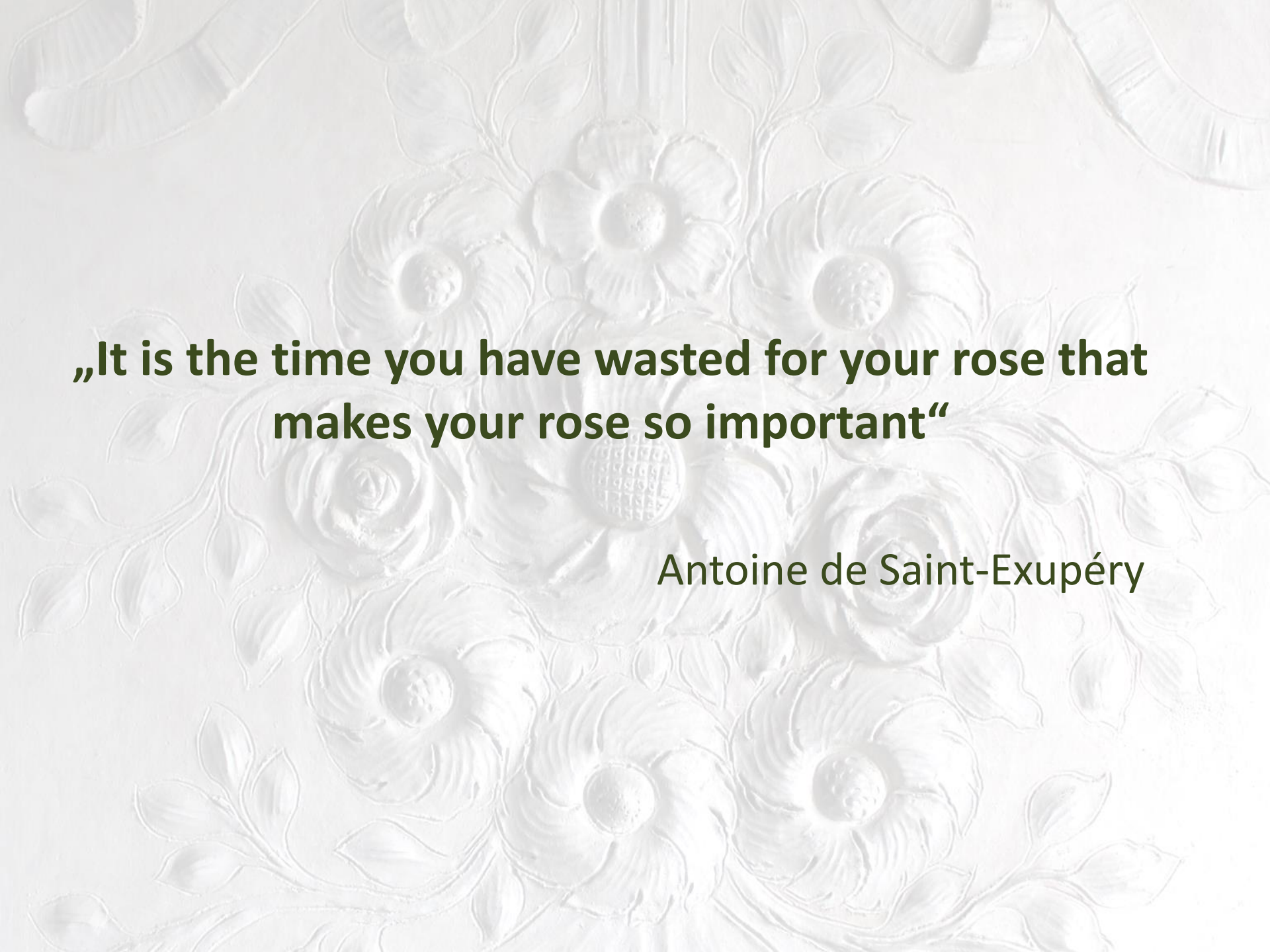

**„It is the time you have wasted for your rose that
makes your rose so important“**

Antoine de Saint-Exupéry



NATIONAL
HERITAGE
INSTITUTE

METHODICAL CENTRE
OF GARDEN CULTURE
IN KROMĚŘÍŽ



Ing. Michaela Letá

National Heritage Institute, The Methodical centre of Garden Culture in Kroměříž, www.npu.cz

Authors of photographs: Mgr. Petr Hudec, Ing. Lenka Křesadlová, Ing. Michaela Letá